

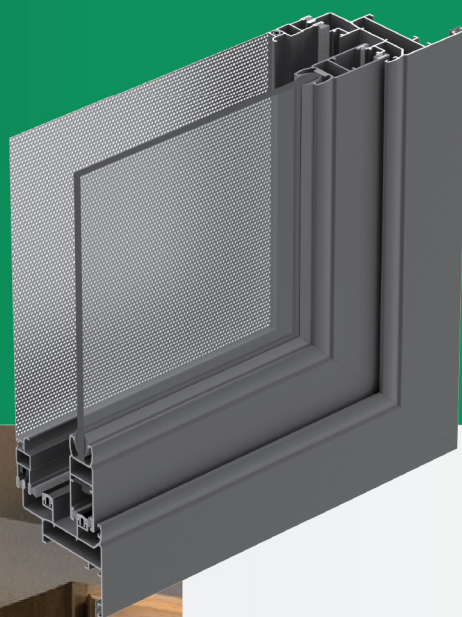

**Machines & Aluminium Center**  
مركز ماكينات ومستلزمات الألومنيوم

# NANO 55

Sliding System



PROFILES 1:1

**2026**  
VER. 01

## **MACHINES AND ALUMINUM CENTER**

Machines and Aluminum Center is an Egyptian based company established in the year 1981 and started its activity with aluminium applications in architectural and construction field.

They represent and cooperate with several leading European firms in field of aluminium business including aluminium fabrication machinery, accessories and hardware for architectural applications and different aluminium systems varying from windows and doors, up to facades and solar protection.

Our goal is to supply our clients with whatever is needed to apply our aluminium systems in the building construction. We are specialized in supplying all required machinery, equipments, dies, punches, hardware and fittings for our aluminium systems.

We offer a wide range of products to local market and neighbor countries. Our product range includes windows and doors, partition systems, different façade solutions and the related integrated accessories.

We partner with our customers with value added services which means that with the help of our specialized team of engineers, we provide our clients with technical support to assist them in improving their product's quality.

We are committed to innovative and creative product design to fulfill all architectural requirements. Our products can meet the most exacting engineering and technical standards while overcoming sophisticated design challenges.



**Machines & Aluminium Center**  
مركز ماكينات ومستلزمات الألومنيوم

The profiles shown in this catalogue are patented. .

The items shown are the exclusive property of **MACHINES & ALUMINIUM CENTER** and may not be even partially reproduced without **MACHINES & ALUMINIUM CENTER** authorization.

The manufacturer reserves the right to modify the items in this catalog without advanced notice.

# TABLE OF CONTENTS

<b>TECHNICAL CHARACTERISTICS.....</b>	<b>5</b>
<b>PROFILES INDEX.....</b>	<b>6</b>
<b>PROFILES SECTIONS 1:1.....</b>	<b>8</b>



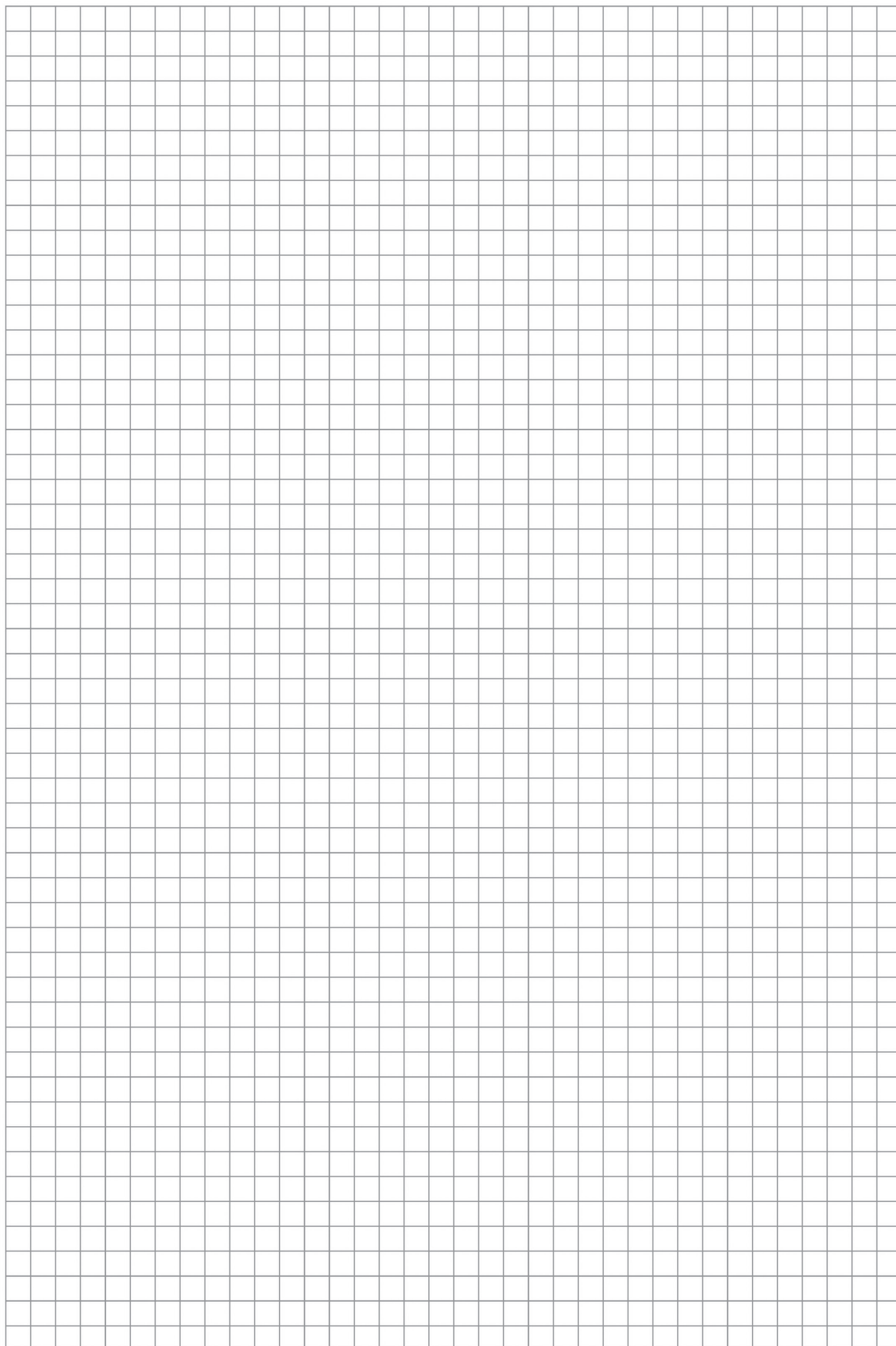

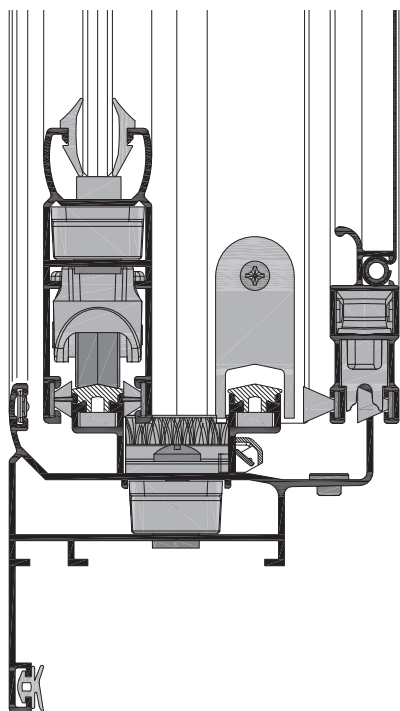
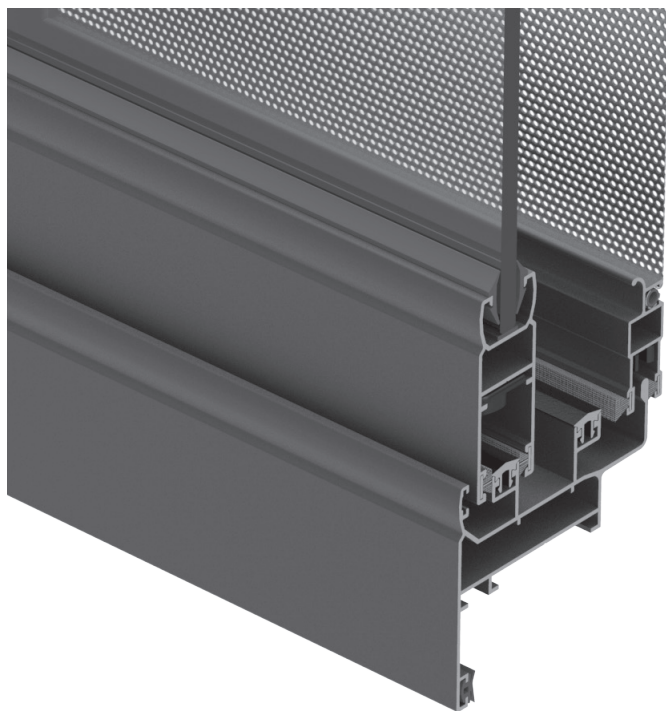
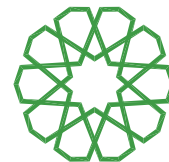

- Ideal solution for small to medium windows for economic residential buildings.
- Offers an extensive range of profiles for the construction of elegant and moderately priced aluminium frames in functional style.
- Offering a very competitive solution.
- Available in the double or triple track design, structures with up to six leaves.
- Most of the accessories can be adjusted and fixed with set screws.

## Technical Characteristics

### Frame Depth

56 mm. to 125 mm.

### Frame Height

37 mm. to 91 mm.

### Sash Depth

22 mm.

### Sash Height

60 mm.

### Max Glass Thickness

Up to 8 mm.

### Max Sash Weight







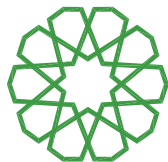

Up to 60 kg.

### Sealing Type







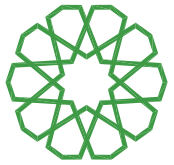

Perimetrical, with two rows of high-density brushes



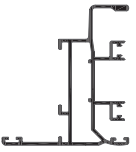
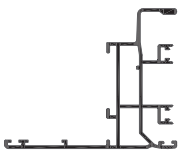

Section	Profile no.	Description	Weight kg/m	Perimeter mm	Inertia		Page No.
					I <sub>x</sub>	I <sub>y</sub>	
	2 055 1310	Frame Profile	0.816	352	10.73	3.74	8
	2 055 1330	Frame Profile	0.936	427	13.89	9.04	8
	2 055 1336	Frame Profile	0.926	426	13.70	8.88	8
	2 055 1356	Frame Profile	1.039	568	27.02	22.46	8
	2 055 1410	Frame Profile	0.971	427	19.60	4.23	9
	2 055 1436	Frame Profile	1.088	502	24.01	9.83	9
	2 055 1450	Frame Profile	1.199	569	27.09	22.64	9
	2 055 1456	Frame Profile	1.194	568	27.02	22.46	9
	2 055 1900	Frame Profile	1.607	634	93.76	7.08	11



Section	Profile no.	Description	Weight kg/m	Perimeter mm	Inertia		Page No.
					I <sub>x</sub>	I <sub>y</sub>	
	2 055 2410	Frame Profile	0.978	436	19.71	3.73	10
	2 055 2420	Frame Profile	1.038	460	19.85	3.95	10
	2 055 2430	Frame Profile	1.114	526	24.62	9.52	10
	2 055 2450	Frame Profile	1.246	574	27.92	21.98	10
	2 055 4210	Leaf Profile	0.608	313	1.93	6.78	11
	2 055 4216	Leaf Profile	0.600	307	1.87	6.65	11
	2 055 4416	Leaf Profile	0.745	342	4.01	6.99	11
	2 055 5210	Transom Profile	0.628	238	1.17	6.90	11
	2 055 9510	Insert Profile	0.254	151	0.58	0.97	11
	2 055 9610	Insert Profile	0.232	88	0.23	0.46	11



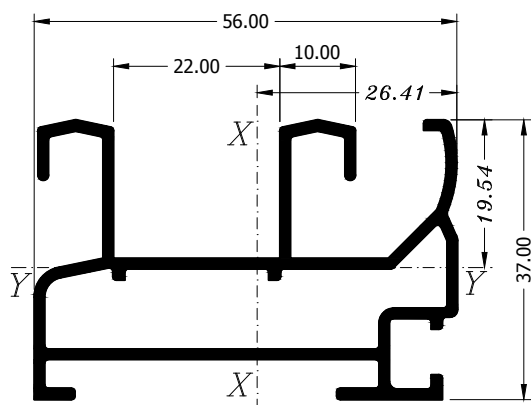

2 055 1310  
0.816 Kg./ml.

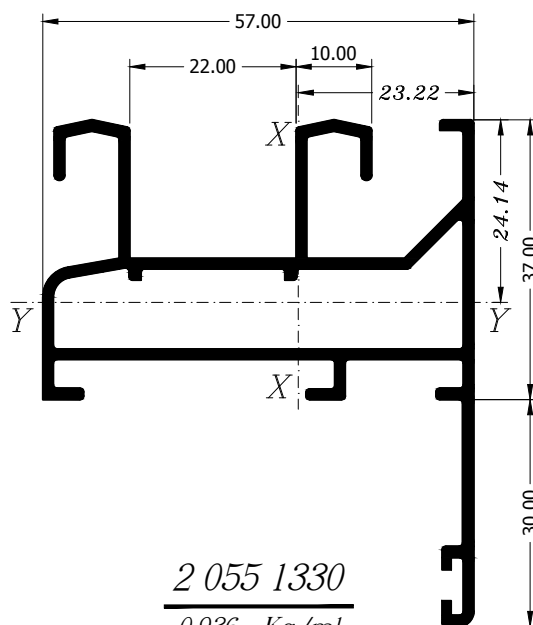

2 055 1330  
0.936 Kg./ml.

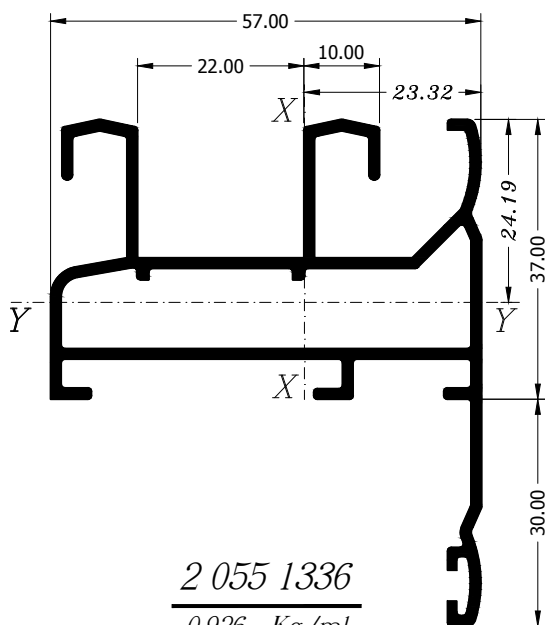

2 055 1336  
0.926 Kg./ml.

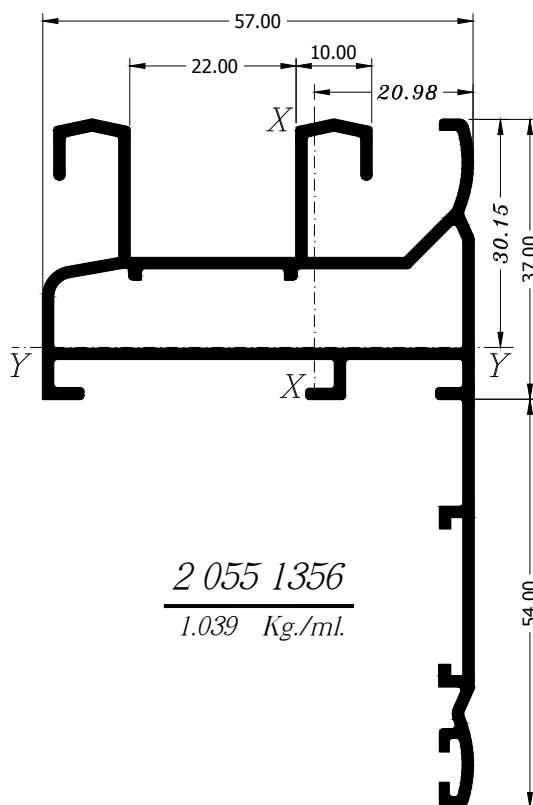

2 055 1356  
1.039 Kg./ml.

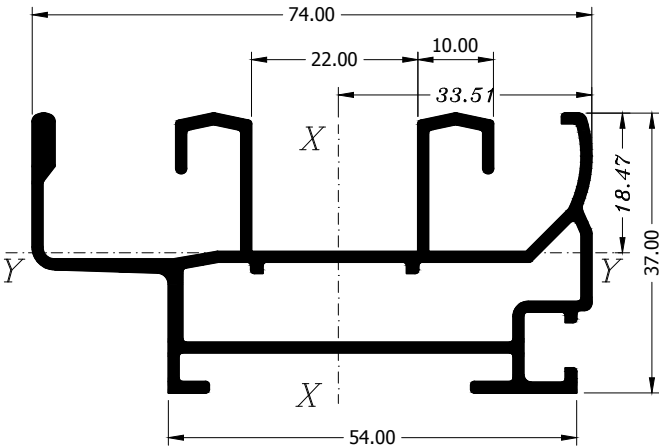

2 055 1410  
0.971 Kg./ml.

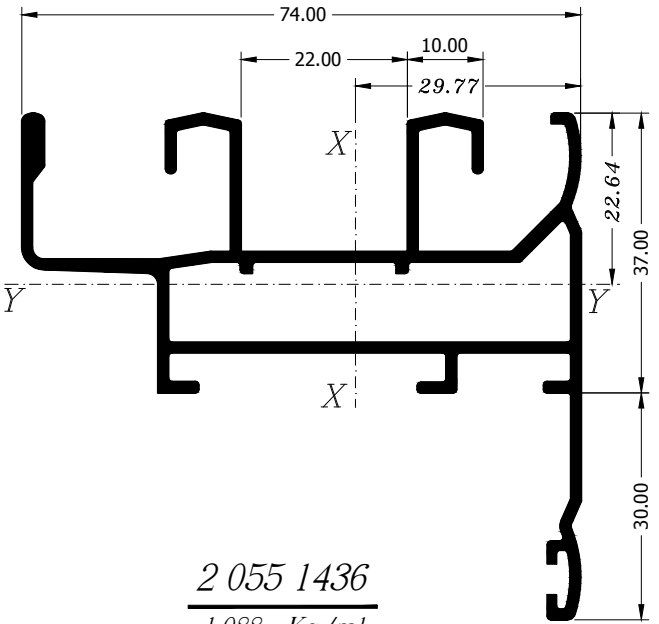

2 055 1436  
1.088 Kg./ml.

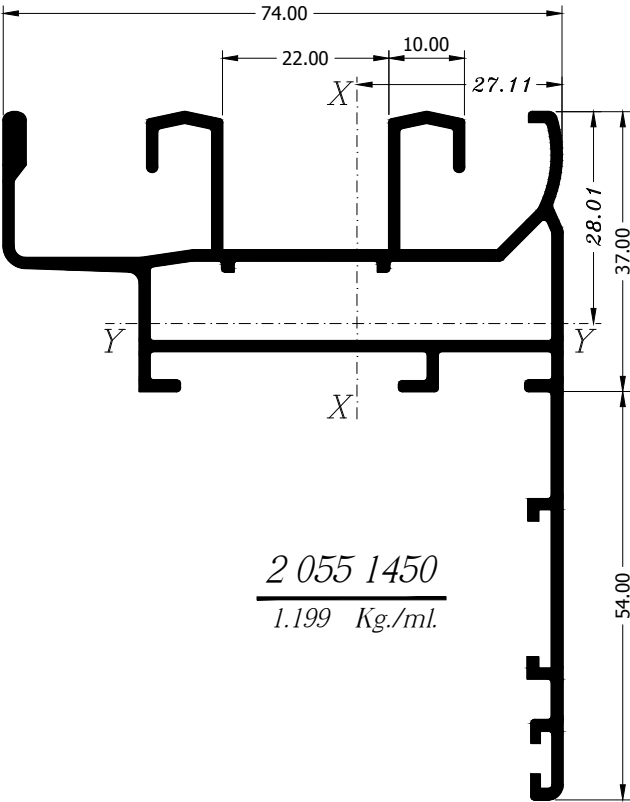

2 055 1450  
1.199 Kg./ml.

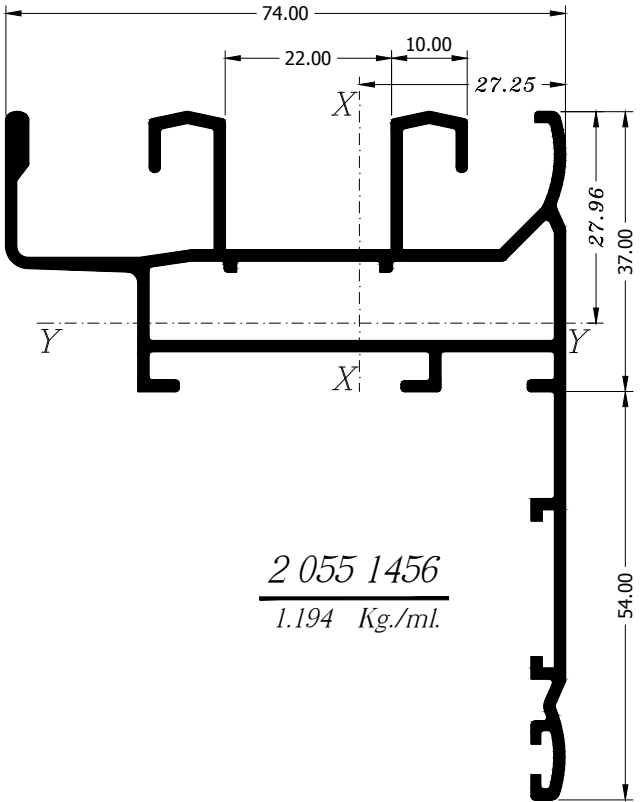

2 055 1456  
1.194 Kg./ml.

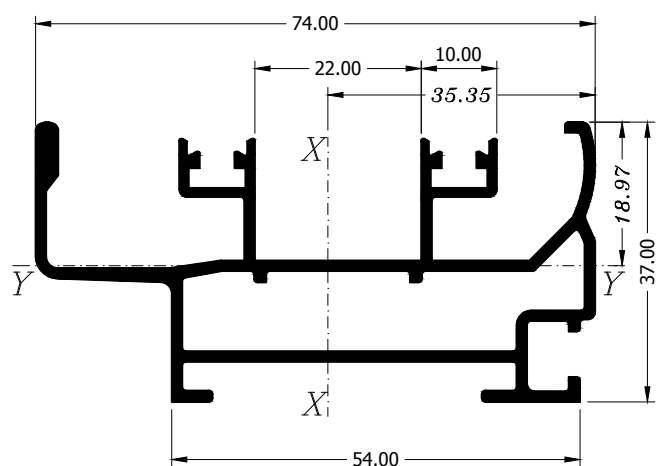

2 055 2410  
0.978 Kg./ml.

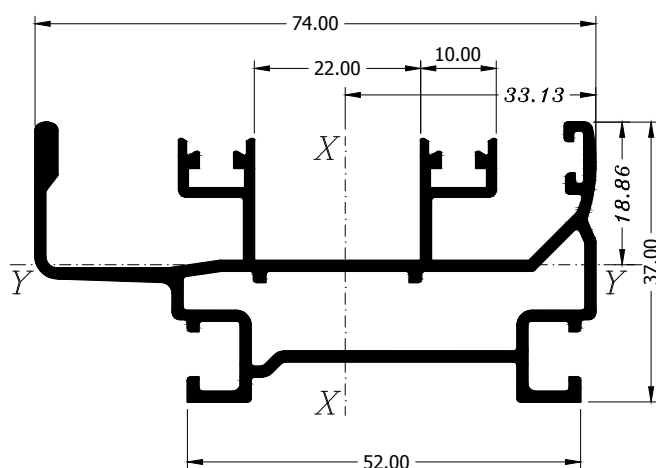

2 055 2420  
1.038 Kg./ml.

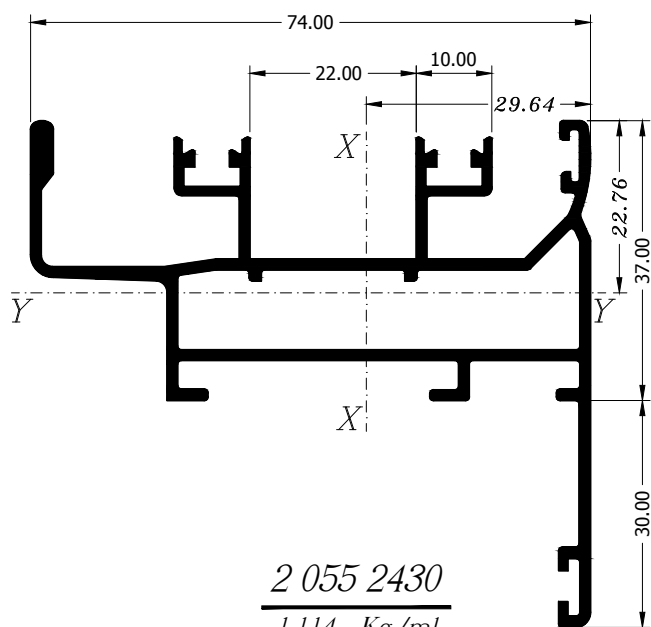

2 055 2430  
1.114 Kg./ml.

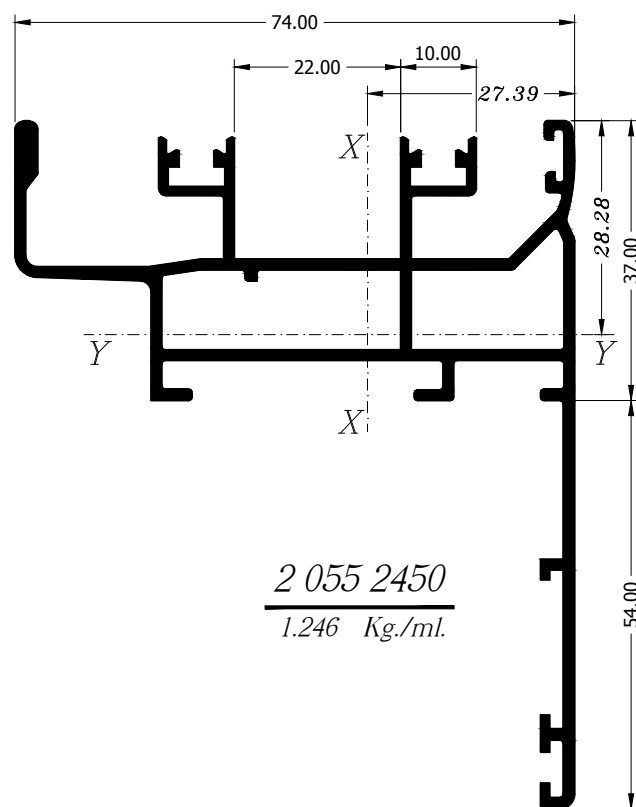

2 055 2450  
1.246 Kg./ml.

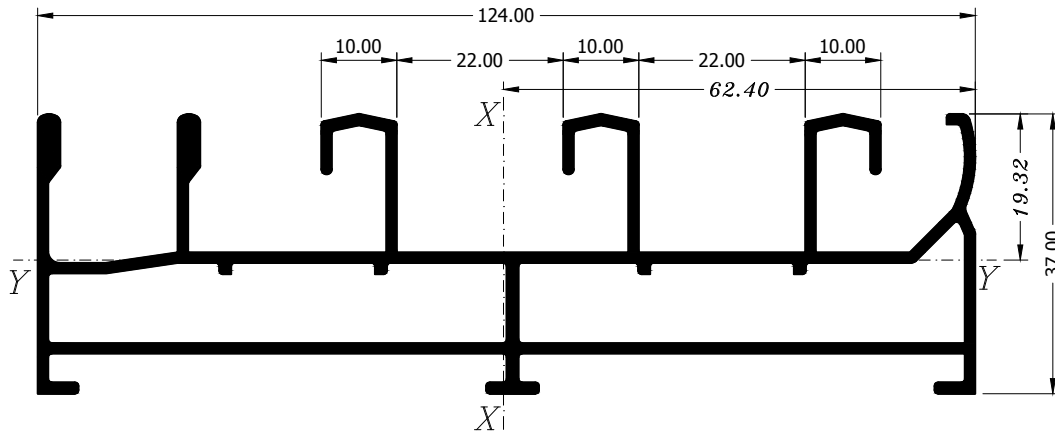

2 055 1900  
1.607 Kg./ml.

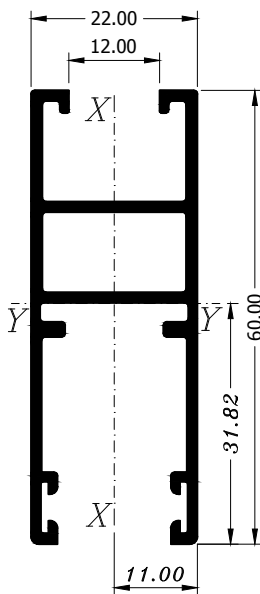

2 055 4210  
0.608 Kg./ml.

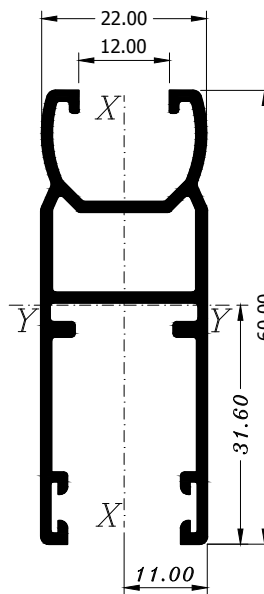

2 055 4216  
0.600 Kg./ml.

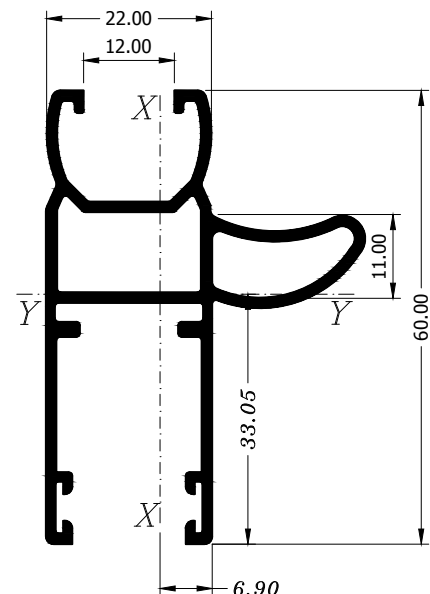

2 055 4416  
0.745 Kg./ml.

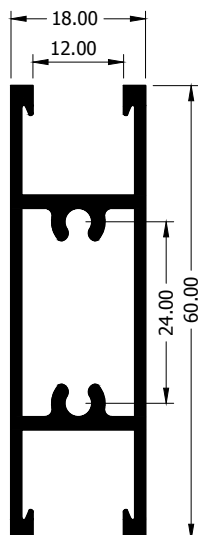

2 055 5210  
0.628 Kg./ml.

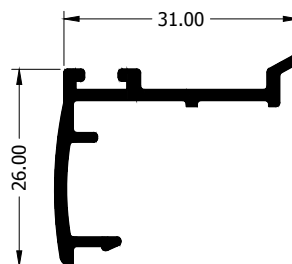

2 055 9510  
0.254 Kg./ml.

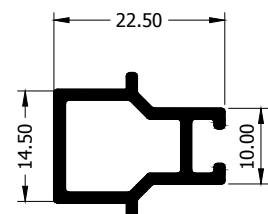

2 055 9610  
0.232 Kg./ml.

All profiles are registered as the property of

**Machines & Aluminium Center - 2026**

122, Mohiy Al-Din Abu Al-Ezz st. , Dokki , Giza. P.O Box: 329 Dokki 12411

Tel: 20 (2) 33363658 - 33363657 - 33360568+ Fax: +20 (2) 33356237

Email: [info@machalum.com](mailto:info@machalum.com)

